



# Concentrated glass and household cleaner



Crew™ is a completely new range of housekeeping cleaning products developed by Diversey keeping in mind the cleaning needs of prosumer customers. With the launch of Crew™ we aim to provide foolproof, simple & high performance cleaning solutions to our customers for superior housekeeping.

## Glass cleaner concentrate

### Description

Crew™ Concentrated glass and household cleaner is suitable for all types of glass and mirrors. Regular cleaning of windows, glass display cases and mirrors with Crew™ Concentrated glass and household cleaner leaves the surface clean and streak-free.

### Features and benefits

- Concentrated for economy of use. Makes 200 litre RTU from one 4 litre can
- Leaves the surface clean and streak-free in one action
- Rapidly removes oily soils and finger marks
- Fast and easy spray-on, wipe-off action
- Pleasant, fresh room care fragrance
- Neutral pH - Highly effective

### Directions for use

Recommended dilution : 20 -50 ml per liter of water depending on the soil level



Mix 20 - 50 ml product (depending on the soil level) with 1 L water.



Fill a spray bottle with the solution and spray onto clean cloth/sponge.



Wipe clean the glass surface with a clean, dry, lint-free cloth.

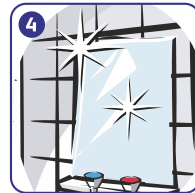

With the lint-free cloth dry and buff to a shine.



Applications :  
Ideal for cleaning of



Mirrors



Window glasses



Glass table tops



TV, etc



**CREW**<sup>TM</sup>

## Concentrated glass and household cleaner



### Glass cleaner concentrate

#### Technical data

Appearance	Blue clear liquid
Specific gravity @25°C	0.98 - 1.0
pH (1 % Solution)	6.5 - 7.5

*The above data is typical of normal production and should not be taken as a specification.*

#### Safe handling and storage information

For external use only. Keep out of reach of children.

Unplug electrical & electronic appliances before using product. Test product on small area of surface before use. Avoid contact with eyes.

In case of eye contact, wash immediately with copious amounts of water. Do not inhale spray. Use with care. For prolonged skin contact, use gloves.

Store in a cool, dry place away from direct sunlight.

#### Available pack size

SKU	Pack size
6295516	2 N X 5 L

#### For More Information

Please contact your local Diversey representative.

#### **Diversey India Hygiene Pvt. Ltd.**

501, 5th Floor, Akruti Centre Point, MIDC Central Road, Andheri (East), Mumbai 400 093. INDIA

Tel.: +91 22 4881 4300 Fax: +91 22 4881 4331

Toll Free No.: 1800 209 2095

[www.diversey.com](http://www.diversey.com)

*Only for professional users / specialists. The manufacturer guarantees the quality of this product. Application recommendations are based on tests and practical experience; the manufacturer declines all responsibility for damages from improper product use.*